

REV.	DESCRIPTION	BY	DATE
0	INITIAL CONTROL	cmansfield	9/21/2009

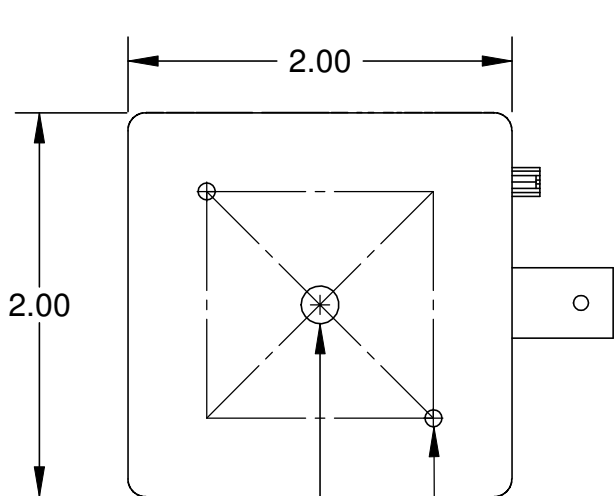

Light Entrance Aperture
 $\phi .20$

4-40 Tapped Holes
 on a 30x30mm Grid
 for Cage Mounting

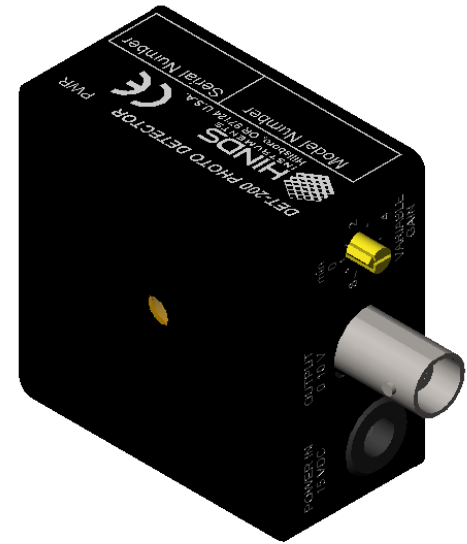
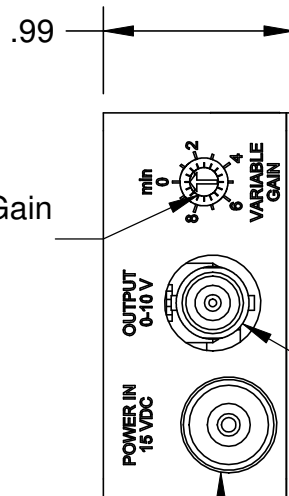

Adjustable Gain
 Dial

Signal Out

15 V Power

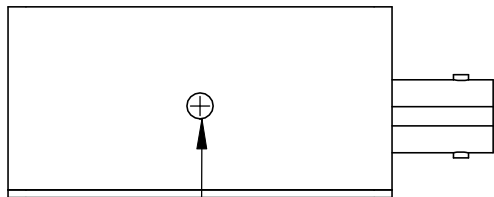

8-32 Tapped Hole
 for Post Mounting

UNSPECIFIED LIMITS DIMENSIONS IN INCHES		DO NOT SCALE DRAWING		HINDS [®] Instruments, Inc. 7245 NW Evergreen Pkwy Hillsboro, OR 97124 PHONE (503) 690-2000 FAX (503) 690-3000				
FRACTIONS	± 1/32	DATE PRINTED		DET-200, OD				
DECIMALS	.XX ± .010 .XXX ± .005	APPROVALS				DATE		
HOLE DIA's	.XX ± .005 .XXX ± .001	DRAWN	9/21/09					
ANGLES	± 0° 30'	CHECKED						
BENDS	± 2°	MATERIAL			SIZE	FSCM NO.	DRAWING NO.	REV.
PERPENDICULARITY	.003/INCH	FINISH			A		09212009-01	0
CONCENTRICITY	.003 TIR	SAMPLES MUST BE APPROVED BY ENGINEERING DEPARTMENT PRIOR TO STARTING PRODUCTION		SCALE	RELEASE DATE:	SHEET	OF	
				1:1		1	1	