

LASER BEAM EXPANDERS

Lasers
Laser Components
Laser Optics

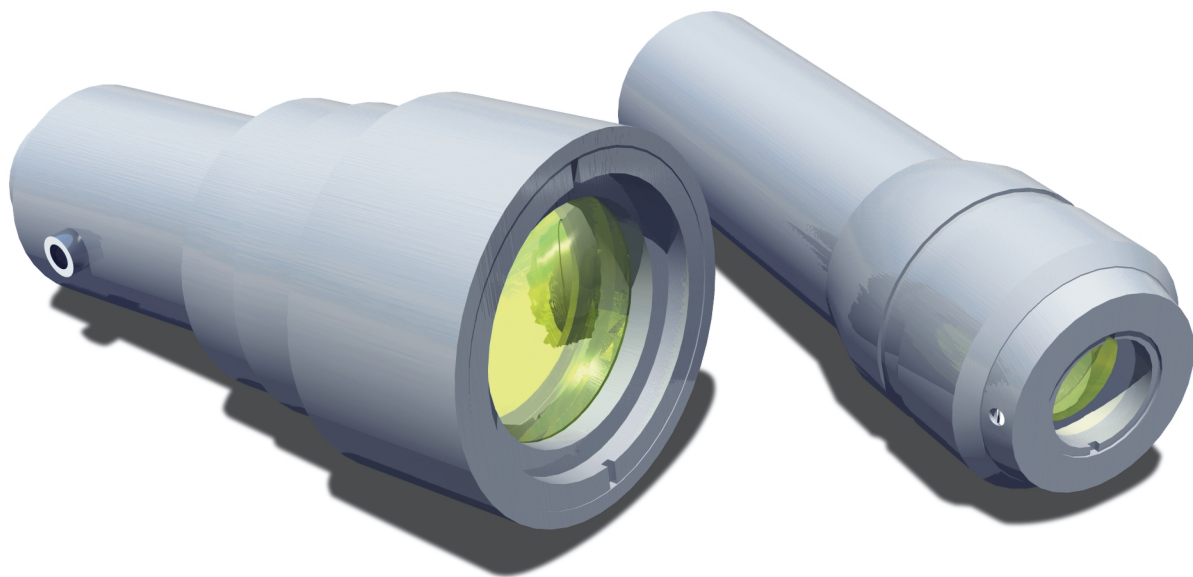

LOTIS TL Series beam expanders are designed for application in Nd:YAG lasers.

A Galilean configuration, entrance fused silica optics and air-spaced optics with AR coatings can withstand high power radiation of Q-switch Nd:YAG lasers (more than 5J/cm² – 10ns 1064nm).

All models are optically corrected for 1064 nm. Some models are also optically corrected for 532 nm. Models for 266 nm and 315 nm are available on request.

SPECIFICATIONS

Model	Expansion ratio	Exit aperture, mm	Dimensions DxL, mm	Maximum input beam, mm
TL 12-1.3	1.3 ^x	12	Ø30x80	8
TL 12-1.5	1.5 ^x	12	Ø30x80	7
TL 12-1.8	1.8 ^x	12	Ø30x90	6
TL 12-2.1	2.1 ^x	12	Ø30x110	5
TL 27-2.5	2.5 ^x	27	Ø44x100	10
TL 27-3.2	3.2 ^x	27	Ø44x120	7
TL 27-4.6	4.6 ^x	27	Ø44x130	5
TL 36-3.6	3.6 ^x	36	Ø56x130	9
TL 36-4.6	4.6 ^x	36	Ø56x130	7
TL 36-7.3	7.3 ^x	36	Ø56x220	4

Beam expander's design subject to change upon request.